

LG-HRx

HDBaseT RECEIVER



LG-HRx is a mini-size HDBaseT Receiver designed with HDBaseT technology to transmit high-resolution 1080p/4k signal from HDBaseT Transmitter to the LG-HRx via a CAT5e/CAT6a cable at a distance up to 70/40 m. Moreover, LG-HRx support CEC, bi-directional RS232&IR control, and unidirectional PoH function.

Features

- Support Full HD delivers high resolution image (1080p@60Hz@48 b/pixels/3D/4Kx2K).
- Maximum transmission distance is 70 m for 1080p and 40 m for 4K x 2K over single CAT5e/CAT6a cable.
- High Bandwidth: 10.2 Gbps.
- HDTV Compatible, use HDMI 1.4 and HDCP 2.2 compliant.
- Support CEC/IR/RS232 pass-through.
- Support PoH, the LG-HRx can be powered by HDBaseT Transmitter.
- Bi-directional RS232/IR control.
- Use HDBaseT technology.
- LED indicators show work status.
- Suitable for LG-SS201M and LG-WP-TR.

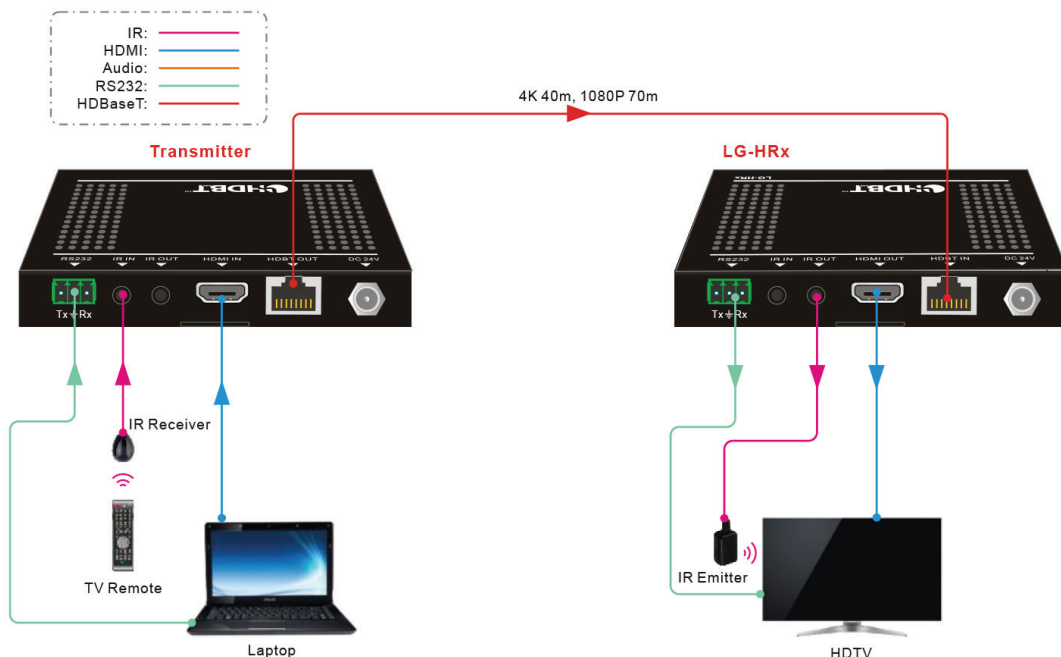

LG-HRx

HDBaseT RECEIVER

Specification

Input Signal	1 x IR; 1 x RJ-45; 1 x RS232
Input Connector	1 x 3.5 mm Mini Jack; 1 x RJ-45; 1 x 3-pin Terminal Block
Audio	Digital audio, Transmit through HDMI audio
Output	1 x HDMI; 1 x IR; 1 x RS232
Output Connector	1 x HDMI female; 1 x 3.5 mm mini jack; 1x3-pin Terminal Block
General	
I/P & O/P Cable Length	3 m
Resolution Range	640x480@60Hz to 4Kx2K@30Hz
Transmission Mode	HDBaseT
Transmission Distance	1080p≤70m; 4Kx2K≤40m through STP cables with STP connectors
Max Data Rate	10.2 Gbps
Impedance	75Ω
Temperature	-20 °C ~ +70 °C
Humidity	10% ~ 90%
Power Supply	Input: 100 VAC~240 VAC, 50/60 Hz Output: DC 24 V, 1.25A
Power Consumption	11 W
Product Weight	0.150 kg
Shipping Weight	0.700 kg
Product Dimension (W x H x D)	115 x 16 x 84 mm
Shipping Dimension (W x H x D)	190 x 130 x 160 mm